

LS-EL5

LASER HOLOGRAPHIC SIGHT

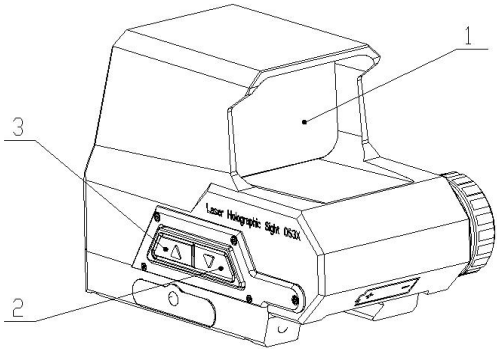

Structure

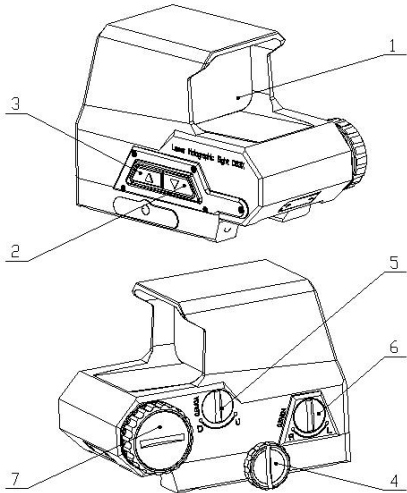

- 1 Observation Window 2 "↓"Button
- 3 "↑"Button 4 Lock Screw
- 5 Elevation Adjustment 6 Windage Adjustment
- 7 Battery Compartment Cover

Battery Installation

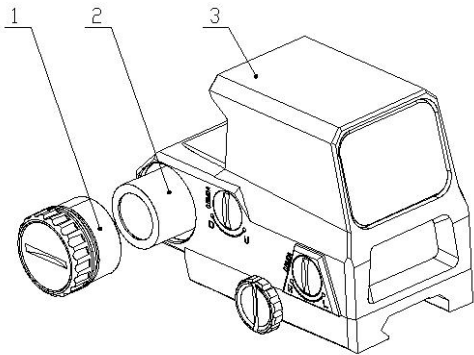

- 1 Battery Compartment Cover
- 2 CR123A 3 Battery Compartment

Rotate the battery compartment cover counterclockwise, place the positive electrode of the battery inward into the battery compartment, and then rotate the battery compartment cover clockwise.

Operation

- 1 Observation Window 2 "↓"Button
- 3 "↑"Button

Power on: Press the "↑" or "↓" button, and the observation window will display a red aiming ring, indicating that the scope has been turned on.

Aiming ring brightness adjustment: The brightness of the aiming ring can be adjusted as needed. During daytime operation, every press of the "↑"button increases the brightness of the aiming ring by one level, and every press of the "↓" button decreases the brightness of the aiming ring by one level; When working at night, long press the "↓" button for 5 seconds to enter night vision mode. In this mode, the brightness of the aimingring can be adjusted by 3 levels. Long press the "↑" key for 5 seconds to exit night vision mode.

Shutdown: Press and hold the "↑" and "↓" buttons simultaneously, the aiming ring disappears, and the system power is turned off.

Specification

Magnification	1×
Field of View(10cm away)	16°× 10°
Aim Ring Brightness	Adjustable
Parallax	≤±2'
Undervoltage Alarm	Aiming Ring Flash
Range of Adjustment for Aiming Ring	
Elevation	≥±10mil
Windage	≥±10mil
Battery Type	CR123A or CR123
Runtime	≥ 500h(Medium Brightness)
Dimension	80mm×50mm×60mm
Weight	< 220g

Delivery Sets

- ☒ LS-EL5 ☒ Manual ☒ Cleaning Cloth
- ☒ Carry Box ☒ Wrench

Mounting

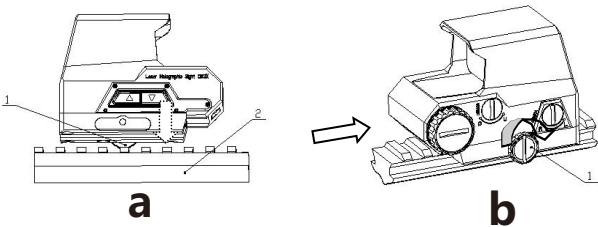

Align the locking screw of the laser holographic sight (see Figure a) with the corresponding Picatinny rail interface and insert it,Push the sight in the direction of the arrow (see Figure b) and align it with the Picatinny guide rail, then tighten the locking screw clockwise (using an adjusting plate).